

**MBSS-1 BARREL PUMP**



Heavy duty industrial grade fuel pumps designed for everyday use in agriculture, construction, automotive & industrial applications.

Rain & weather proof for tough outdoor use.

Compact & light weight construction.

Silenced motor makes almost no noise.

Stainless steel filter built into the suction tube inlet prevents contaminants from getting in & causing damage.

**Duty cycle :-** 8 minutes on/ 3 minutes off

- x **Overall size of pump(L x W x H):-** 1375 x 300 x 140mm
- x **Packing size(L x W x H):-** 1470 x 310 x 260 mm
- x **Pump weight:-** 8.6 kg
- x **Pump weight with packing:-** 13 kg

**Specification :-**

- x **Motor type :-** AC motor
- x **AC power cable length :-** 1.8 meter
- x **Max. Viscosity of media :-** 100 centipoise
- x **Temperature :-** 5°C to 40°C

**Wetted components**

Stainless steel

**Recommended use**

Diesel, Kerosene, Bio diesel, DEF, Adblue, Water based media, Antifreeze, Detergents, Light oils with viscosity upto 100 centipoise.

**Not to use with**

Gasoline, Corrosive chemicals, Lacquer thinner, any material that is not compatible with the pump construction.

**MBSS-1 BARREL PUMP**

**Description :-**

- x Inlet pipe diameter :-  $\text{Ø}43 \text{ mm}$
- x Outlet size :- 1" BSP Connection
- x Power :- 1hp
- x Speed :- 18000 rpm
- x Voltage :- 220 volt, 50 hz
- x Phase :- Single

**Drawing :-**

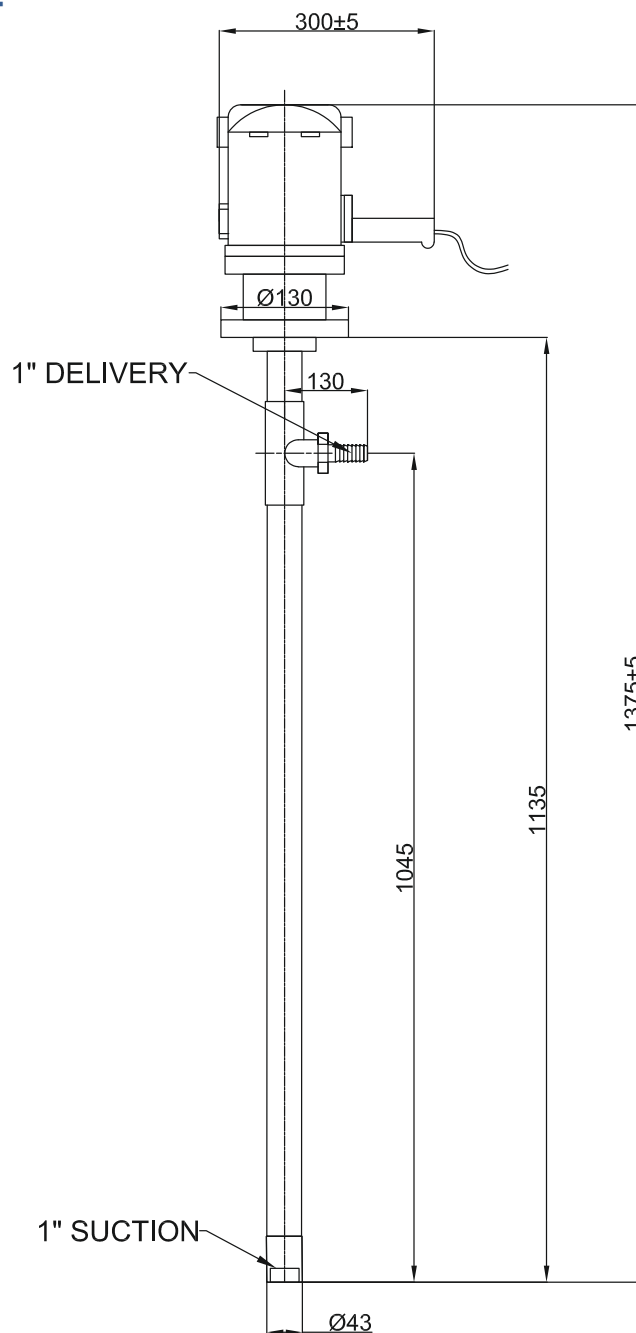

## MBSS-1 BARREL PUMP

Performance table :-

TYPE TEST RECORD SHEET				CREATIVE ENGINEERS										
Model : <b>MBSS-1</b>		K.W : 1.50		<b>230 V / 1 PH / 50 HZ / AC SUPPLY</b>										
Gauge Dis. : <b>0</b>		Suc. Size : 42 mm		Performance at rated Speed : <b>18000</b>										
Del. Size : 25 mm		Capacity measured by : Flow meter		Suction lift measured by : Vacuum Gauge				Motor Effi. Reference : Performance curve at full load, rpm Nature of test - Performance test as per IS :						
Delivery head measured by : Pressure Gauge														
Sr. No.	Del Head meter	Suc Head meter	Total meter	Motor i/p kw	Current amp	Freq. Hz	Speed rpm	Disch. lpm	Head meter	Motor i/p kw	Disch. lpm	Pump o/p kw	Efficiency %	
1	1.0	0.0	1.0	0.713	3.1	50.0	18000	60	1.00	0.713	60.00	0.010	1.38	
2	5.0	0.0	5.0	0.575	2.5	50.0	18000	47	5.00	0.575	47.00	0.038	6.68	
3	10.0	0.0	10.0	0.552	2.4	50.0	18000	25	10.00	0.552	25.00	0.041	7.40	
4	15.0	0.0	15.0	0.506	2.2	50.0	18000	14	15.00	0.506	14.00	0.034	6.78	
5	18.0	0.0	18.0	0.483	2.1	50.0	18000	0	18.00	0.483	0.00	0.000	0.00	

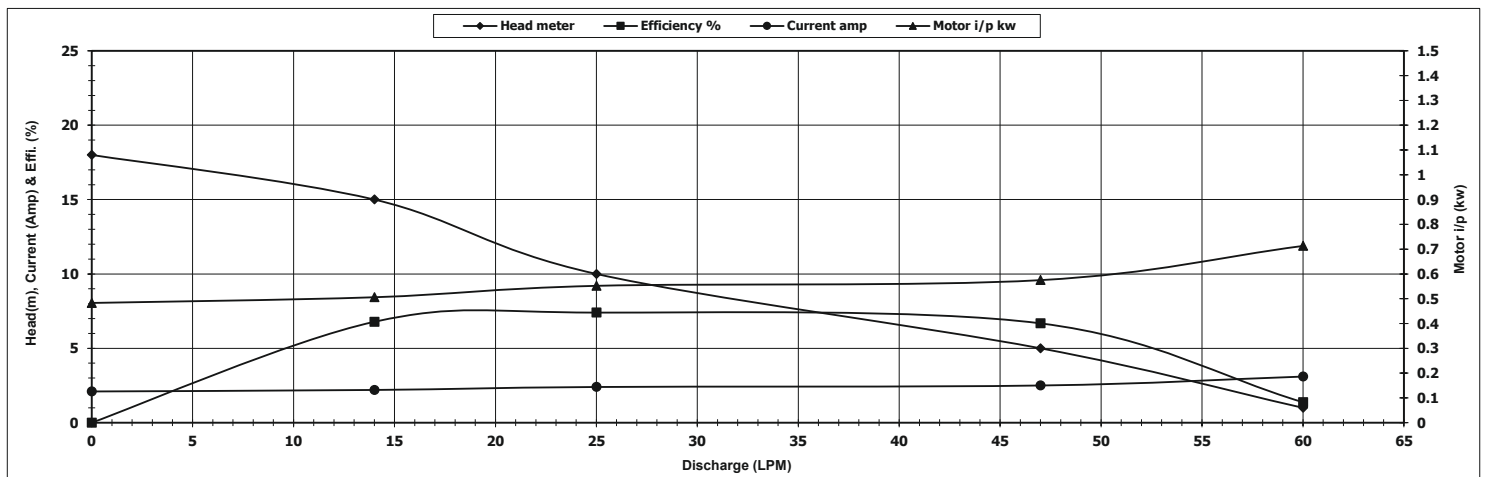

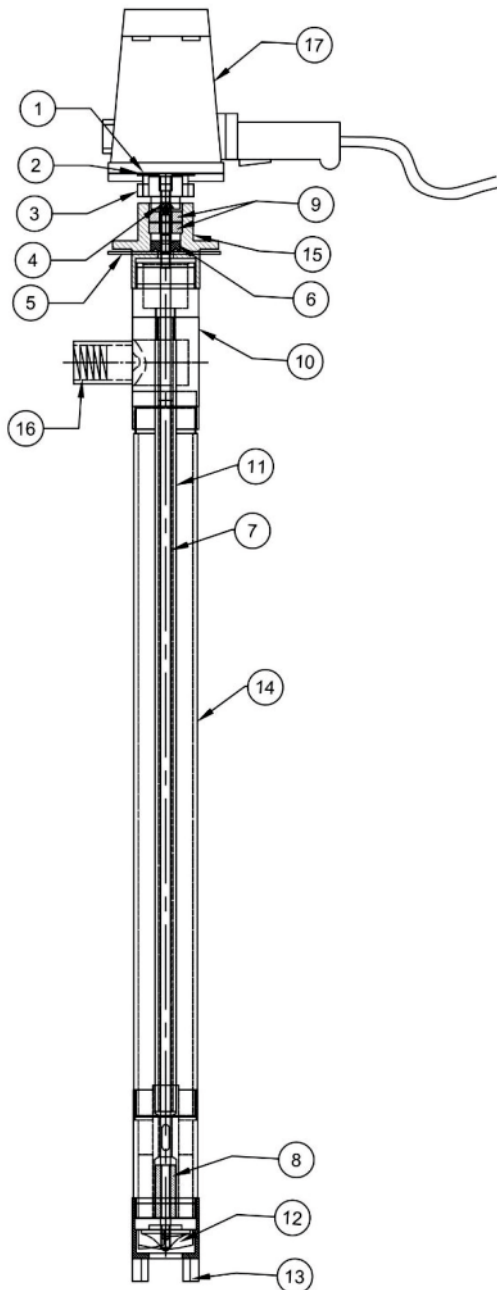
**MBSS-1 BARREL PUMP**
**Cross section drawing**

NO.	PART NAME	QTY.	MATERIAL
1	SNAP RING (SMALL)	1	SS - 316
2	COUPLING CROSS	1	SS - 316
3	COUPLING HOUSING	1	CI
4	BEARING SHAFT	1	SS - 316
5	SNAP RING(BIG)	1	SS - 316
6	LIP SEAL	1	TEFLON
7	SHAFT	1	SS - 316
8	BUSH BEARING	1	TEFLON
9	BALL BEARING	2	SS
10	DISCHARGE TEE	1	SS - 316
11	INNER PIPE	1	SS - 316
12	IMPELLER	1	SS - 316
13	PUMP BASE	1	SS - 316
14	OUTER PIPE	1	SS - 316
15	BEARING HOUSING	1	CI
16	OUTLET CONNECTION	1	SS
17	MOTOR	1	-